



# NEW AFFORDABLE DELUXE APARTMENT

*The Perfect Place for Perfect Living*



**SPRINGHILL**  
**TERRACE**  
RESIDENCES



Sandalwood Tower

Oakwood Tower

2 Tower Apartemen • Balkon di Setiap Unit • Sky Lounge • Rooftop Garden • Swimming Pool • Security 24 jam • Green Environment • Di kawasan Springhill & Berdampingan dengan Swiss-Bellin Springhill Hotel & Office • Dekat Lapangan Golf & Driving Range Kemayoran (18 Hole) • Dekat Hutan Kota 30HA • Jalan Selebar +110M • Bebas Banjir • Bebas Macet • Bebas 3 in 1 • Akses Tol Langsung • Dekat Fasilitas Sekolah Internasional • Rumah Sakit Internasional



Rooftop Garden

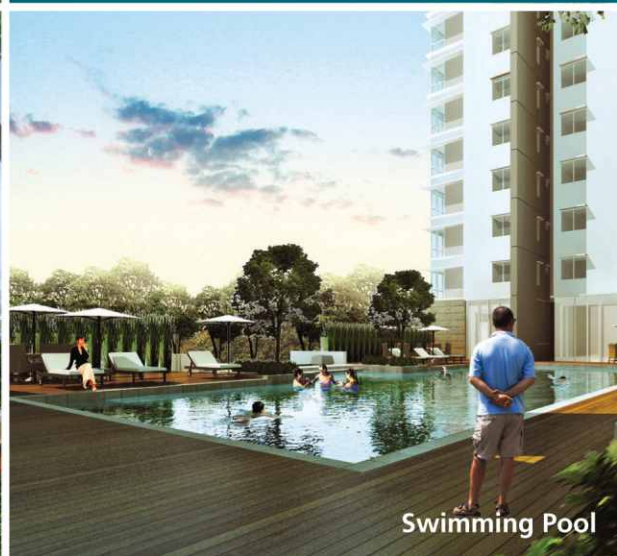

Swimming Pool



## STUDIO



**UNIT STUDIO - A (F & M)**  
SEMI GROSS = 32,96 m<sup>2</sup>



**UNIT STUDIO - B (A1 & A2)**  
SEMI GROSS = 37,96 m<sup>2</sup>

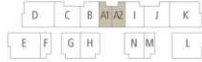

## TWO BEDROOM



**UNIT 2BR - A (B, I & G)**  
SEMI GROSS = 58,23 m<sup>2</sup>



**UNIT 2BR - B (N & H)**  
SEMI GROSS = 60,88 m<sup>2</sup>



## THREE BEDROOM



**UNIT 3BR (C & J)**  
SEMI GROSS = 73,66 m<sup>2</sup>



**UNIT 3BR (alt.) (C & J)**  
SEMI GROSS = 73,66 m<sup>2</sup>



**UNIT 3BR + Maid (D, E, K & L)**  
SEMI GROSS = 99,67 m<sup>2</sup>



**2ND - 32RD  
FLOORPLAN  
OAKWOOD  
TOWER**

### TECHNICAL SPECIFICATION

Lobby	: Marble	- Wall Split AC in all bedroom (Optional)	- Salon
Living Room	: Homogeneous Tile (Optional)	- Electricity Supply Studio 2.200 VA	- GYM / Fitness Club
Bedroom	: Homogeneous Tile (Optional)	- 2 & 3 BR 3.500 VA	- SPA
Bathroom	: Ceramic Tile	- Water Supply PDAM	- Kindergarten
Kitchen	: Homogeneous Tile (Optional)	- Telephone Line	- Apotik
Balcony	: Ceramic Tile	- 3 Lift + 1 Lift service	- Mini Market
Ceiling	: Painted Gypsum Board (Optional)	- Jogging Track	- Laundry & Dry Cleaning
Other value	- Sky Lounge	- 2 lantai parkir	- Children Care
	- Rooftop Garden	- Cafe	- Mailing Service
			- Business Solutions
			- ATM

**SPRINGHILL GROUP** Corporate Founding Member of Green Building Council Indonesia

021 **654 9999** Marketing Gallery:  
 SMS Centre 0817 654 9999 Jl. Benyamin Suae Blok D 7, Kemayoran - Jakarta 14410  
[www.springhillgroups.com](http://www.springhillgroups.com)

Member of **SPRINGHILL GROUP** Corporate Founding Member of Green Building Council Indonesia

sebagai hunian dengan "Taman Terbang Terpanjang di Indonesia (3.15 Km)"

While every reasonable care has been taken in preparing this brochure, the developer and its agents cannot be held responsible for any inaccuracies. All statements are believed to be correct but are not to be regarded as final statements or representations of fact. All information and specifications are current at time of print and are subject to changes as may be required and cannot form part of an offer or contract. All plans are subject to any amendments approved by the relevant authority. Illustrations shall not be regarded as representation of fact. The size and dimension are approximate measurements using equipment/criteria and method determined by the developer.

